

Drilling Template



A technical diagram of a drilling template. It consists of a long, thin rectangle with a thick black border. Inside, there are two identical vertical oval shapes, one on the left and one on the right. Each oval contains three circular holes: one at the top, one in the middle, and one at the bottom. The top and bottom holes are marked with a cross symbol, indicating they are for screws. The middle hole is larger and has a vertical line through its center. A horizontal dashed line runs through the center of the rectangle, passing through the middle of all six holes. The text 'PLEASE USE A SPIRIT LEVEL' is written in green, bold, uppercase letters across the middle of the rectangle, just below the dashed line.

PLEASE USE A SPIRIT LEVEL

! WARNING ! When installing the knife strip, remove sharpener and reattach once installation is complete to avoid injury or damage

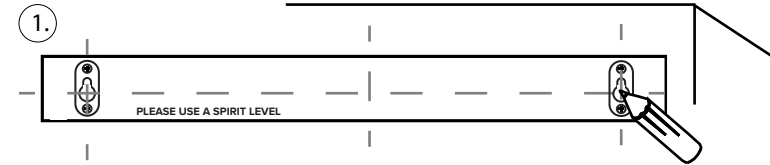

Using a spirit level, position the template provided, mark 2 holes on the wall in the centre of the hanging slot. Remove template after marking the wall.

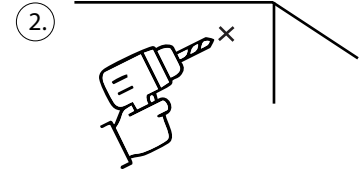

Drill x2 holes in the wall, in the marked positions, being careful to avoid any buried wires.

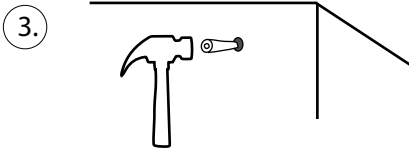

Insert the wall plugs provided into the holes and carefully tap them flush to the wall using a hammer.

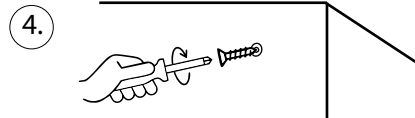

Using a screw driver (**electric drill is not recommended**) screw the screws into the wall leaving the head ~1.0cm away from the wall so it can latch onto the knife strip slot.

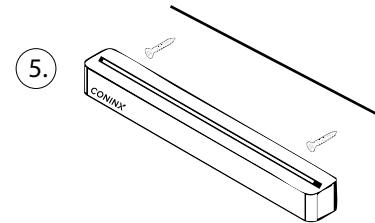

Hang the knife strip from the screws, If it is too tight or loose repeat step 4 adjusting the screw head clearance from wall.

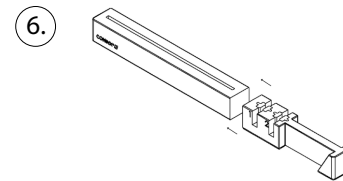

Reattach the knife sharpener to the strip. To use, take sharpener off wall, place on counter, run knife through blades, honing first then sharpening